

GENERAL NOTES

The drawings should be read in conjunction with the MSB specifications and Employer's Requirements. Any discrepancy between the documents should be advised back to the Employer's Representative and the design team. The Employer's Representative shall be advised as an addendum.

When issuing tender information for sub-contractor pricing drawings and specifications to enable informed pricing that includes all the items necessary for the completion and migration of the works as required by the design. Incomplete information leads to incomplete pricing. Tenderers should be aware of the design and tendering process and consider to include for all the required items.

Contractor proposals should include a compliant tender drawings and specifications to enable informed pricing that includes all the items necessary for the completion and migration of the works as required by the design. Incomplete information leads to incomplete pricing. Tenderers should be aware of the design and tendering process and consider to include for all the required items.

HEALTH, SAFETY & ENVIRONMENT

The proposed works have been planned through a risk assessment. The planning and execution of the works should take into account all local and specific hazards. Hazards should be identified and controlled through the design and construction and demolition of the works.

Excavation: All services present in site, soil tests, hazardous materials, and other services should be identified and controlled through the design and construction and demolition of the works.

Overhead cables: Overhead cables may be present above the works area. Contractors should be aware of the location and height of overhead cables and ensure that all work is carried out safely.

Use of soil: Soil should be stored in a secure area and used as specified in the design. Soil should be stored in a secure area and used as specified in the design.

Use of large and excavated items: Large items and excavated items should be stored in a secure area and used as specified in the design.

Use of heavy machinery: Heavy machinery should be used in a safe and controlled manner. Contractors should be aware of the location and height of heavy machinery and ensure that all work is carried out safely.

Use of heavy machinery: Heavy machinery should be used in a safe and controlled manner. Contractors should be aware of the location and height of heavy machinery and ensure that all work is carried out safely.

Use of heavy machinery: Heavy machinery should be used in a safe and controlled manner. Contractors should be aware of the location and height of heavy machinery and ensure that all work is carried out safely.

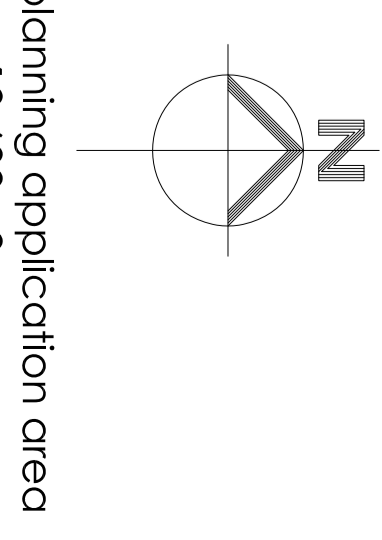

Red line planning application area
18.632m²

Development site - 17.427m²

Units
8,480m² GEA (7,445+1,015m²)

Car parking - 134 spaces
of which 14 are disabled spaces
Cycles - 49

16 water cycle spaces in 2 covered shelters

Cycles inside the units

Bicycle vehicle changing spaces

Fence line - 2.4m high black Paladine fence

Gas cabinet (with 2 protection bollards) along all boundaries

A/C condensate (with/without bollards)

Estate road - HR4

Pavements - Macadam

Car parking areas

Charcoal (dark grey) block paving

Building patios

Natural (light grey) block paving

Yard areas - f.c. slab

Building footprint

Existing concrete hedge

Proposed tree

Plant bed

Gross area

Existing landscaped areas outside the applicant's ownership boundary to be restored

Existing landscaped areas outside the applicant's ownership boundary to be restored

Existing landscaped areas outside the applicant's ownership boundary to be restored

Existing landscaped areas outside the applicant's ownership boundary to be restored

Existing landscaped areas outside the applicant's ownership boundary to be restored

Existing landscaped areas outside the applicant's ownership boundary to be restored

Existing landscaped areas outside the applicant's ownership boundary to be restored

Existing landscaped areas outside the applicant's ownership boundary to be restored

Existing landscaped areas outside the applicant's ownership boundary to be restored

Existing landscaped areas outside the applicant's ownership boundary to be restored

Existing landscaped areas outside the applicant's ownership boundary to be restored

Existing landscaped areas outside the applicant's ownership boundary to be restored

Existing landscaped areas outside the applicant's ownership boundary to be restored

Existing landscaped areas outside the applicant's ownership boundary to be restored

Existing landscaped areas outside the applicant's ownership boundary to be restored

Existing landscaped areas outside the applicant's ownership boundary to be restored

Existing landscaped areas outside the applicant's ownership boundary to be restored

Existing landscaped areas outside the applicant's ownership boundary to be restored

Existing landscaped areas outside the applicant's ownership boundary to be restored

Existing landscaped areas outside the applicant's ownership boundary to be restored

Existing landscaped areas outside the applicant's ownership boundary to be restored

Existing landscaped areas outside the applicant's ownership boundary to be restored

Existing landscaped areas outside the applicant's ownership boundary to be restored

Existing landscaped areas outside the applicant's ownership boundary to be restored

Existing landscaped areas outside the applicant's ownership boundary to be restored

Existing landscaped areas outside the applicant's ownership boundary to be restored

Existing landscaped areas outside the applicant's ownership boundary to be restored

Existing landscaped areas outside the applicant's ownership boundary to be restored

Existing landscaped areas outside the applicant's ownership boundary to be restored

Existing landscaped areas outside the applicant's ownership boundary to be restored

Existing landscaped areas outside the applicant's ownership boundary to be restored

Existing landscaped areas outside the applicant's ownership boundary to be restored

Existing landscaped areas outside the applicant's ownership boundary to be restored

Existing landscaped areas outside the applicant's ownership boundary to be restored

Existing landscaped areas outside the applicant's ownership boundary to be restored

Existing landscaped areas outside the applicant's ownership boundary to be restored

Existing landscaped areas outside the applicant's ownership boundary to be restored

Existing landscaped areas outside the applicant's ownership boundary to be restored

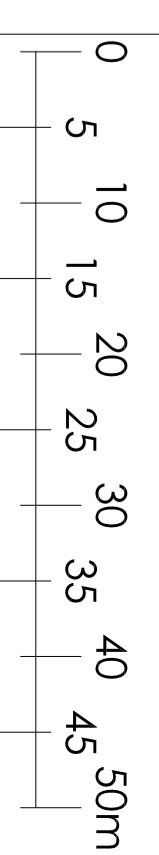
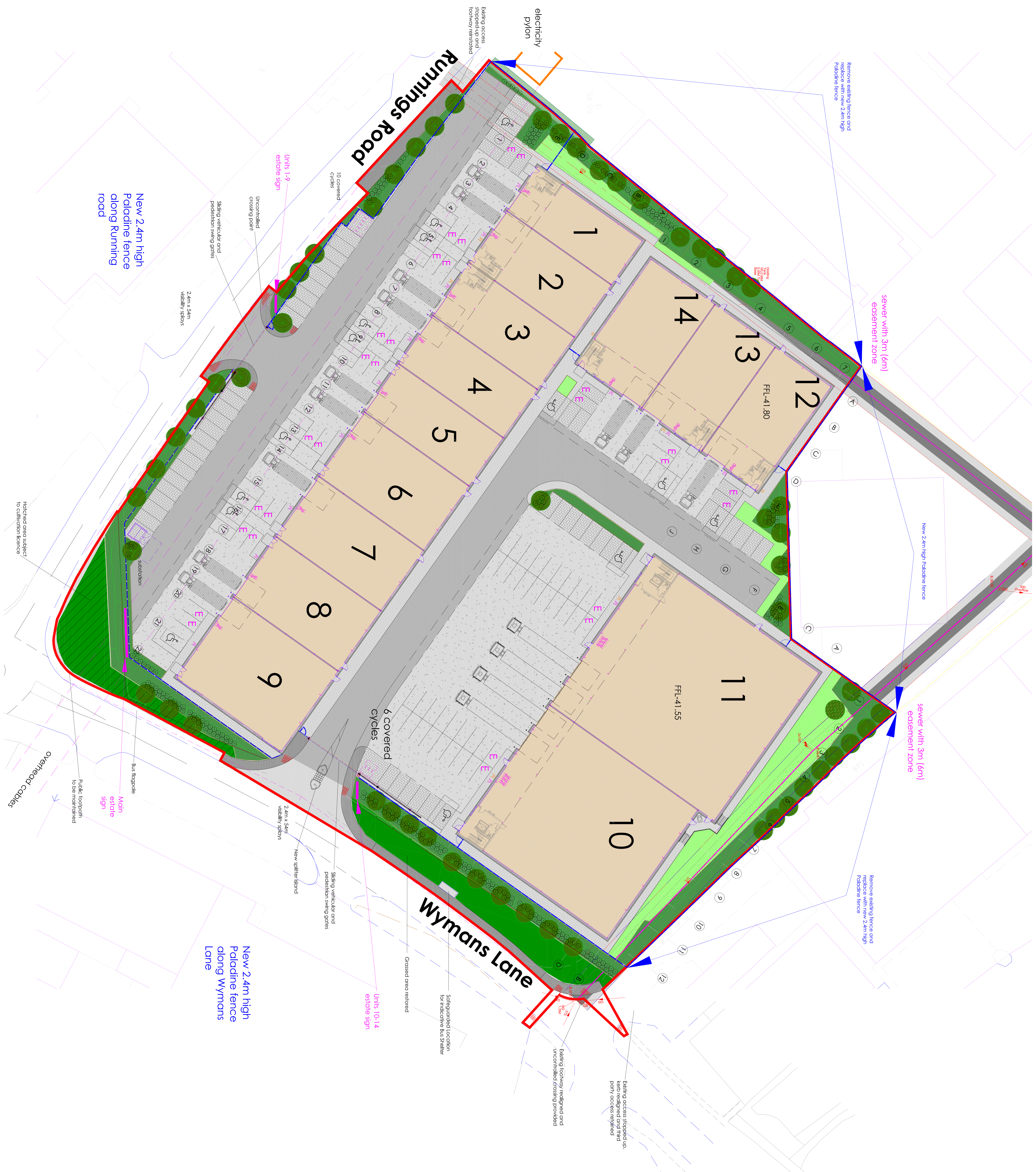

Tender

Rev. D	
Rev. C	
Rev. B	
Rev. A	

Notes
No dimensions are to be scaled from this drawing. Contractors must verify all figured dimensions at the drawing's construction site. If any discrepancy is found, the contractor must advise the architect immediately. This drawing is the sole copyright of IAN C KING ASSOCIATES. No part of this drawing may be reproduced without the written consent of the above.

Chancenygate
Cheltenham

Units 1-14
Site Plan

Date: 12-2019
Scale: 1:250 (A0)

IAN C KING ASSOCIATES - ARCHITECTS
5, St George's Court
1st Floor
1st Runny, Wyke Road
Cheltenham, Gloucestershire
GL51 6AA
Tel: 01202 85870
Fax: 01202 85937
www.iancking.co.uk